

Installation & Maintenance Instructions

2-WAY INTERNAL PILOT-OPERATED SOLENOID VALVES
NORMALLY CLOSED OPERATION - 3/4", 1", 1 1/4", 1 1/2" OR 2" NPT
FUEL GAS SERVICE

SERIES
8214(200)

NOTICE: For instructions and exploded view, see I&M No. V_9565_R4 - Section 1.

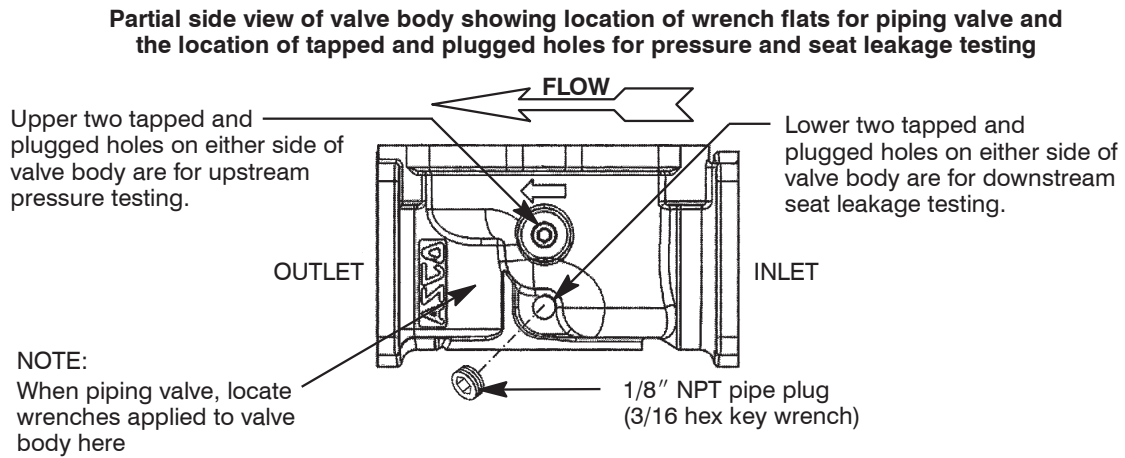

Figure 1. Provisions for wrench flats for piping valve and for pressure and seat leakage testing

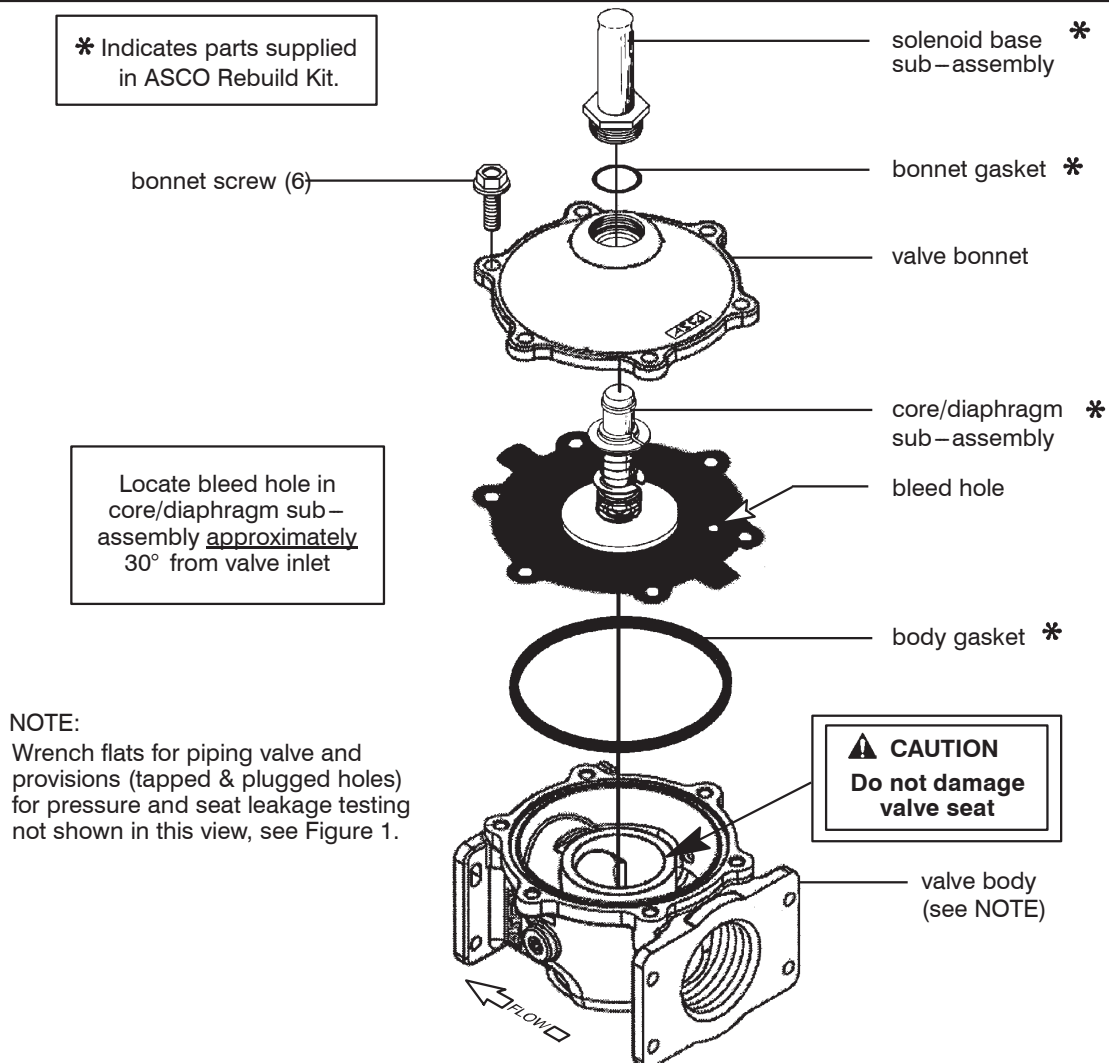
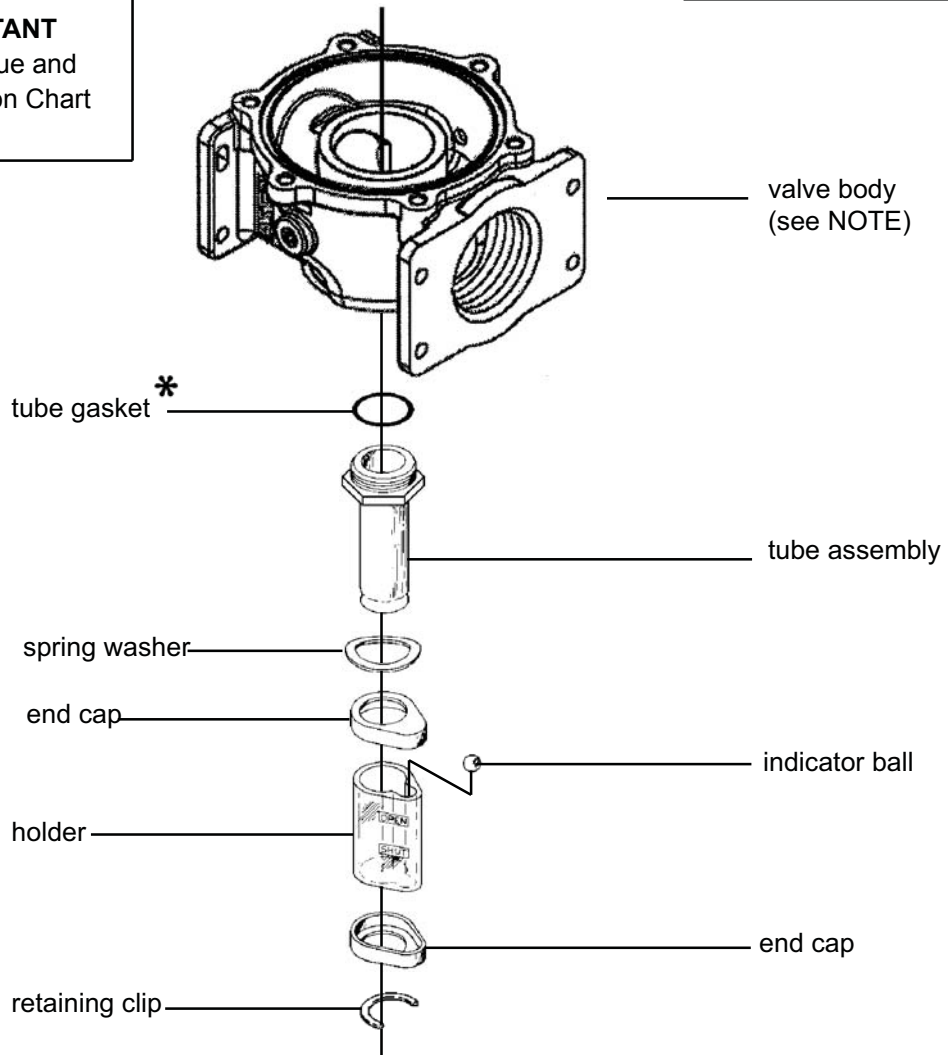

Figure 2. Series 8214G(200) valve without solenoid, AC construction shown

Suffix VI

IMPORTANT
See Torque and
Lubrication Chart

* Indicates parts supplied in
ASCO Rebuild Kit



NOTE:
Wrench flats for piping valve and provisions (tapped & plugged holes) for pressure and seat leakage testing not shown in this view, see Figure 1.

Figure 3. Visual position indicator (partial view)

Suffix C

IMPORTANT
See Torque and Lubrication Chart

Locate bleed hole in core/diaphragm sub-assembly approximately 30° from valve inlet

Rebuild Kits are not available for valves with Suffix C.

CAUTION
Do not damage valve seat

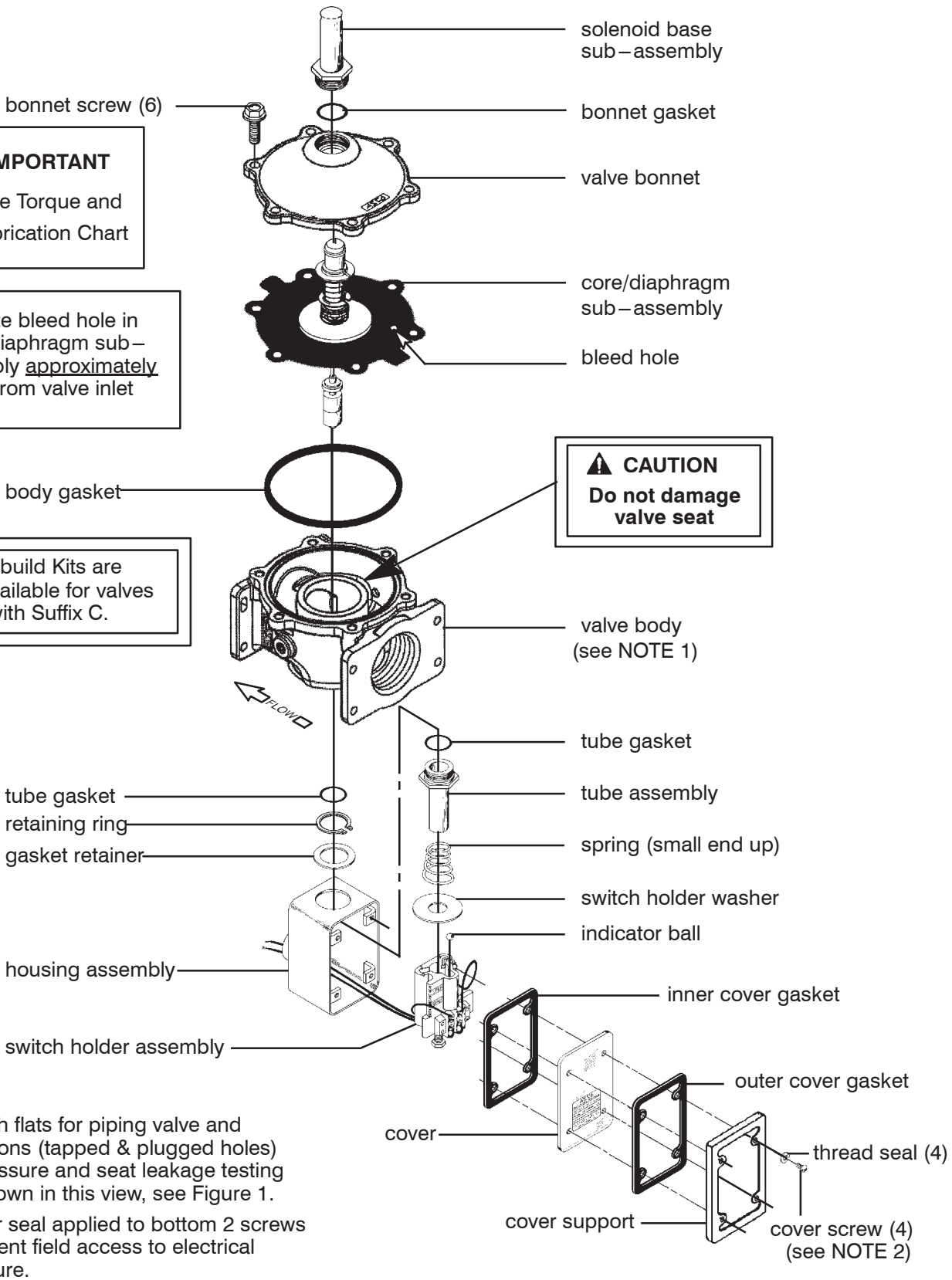

NOTES:

1. Wrench flats for piping valve and provisions (tapped & plugged holes) for pressure and seat leakage testing not shown in this view, see Figure 1.
2. Tamper seal applied to bottom 2 screws to prevent field access to electrical enclosure.

Figure 4. Series 8214G(200) with electrical and visual position indicator

To illustrate leakage testing only.
Not for system layout.

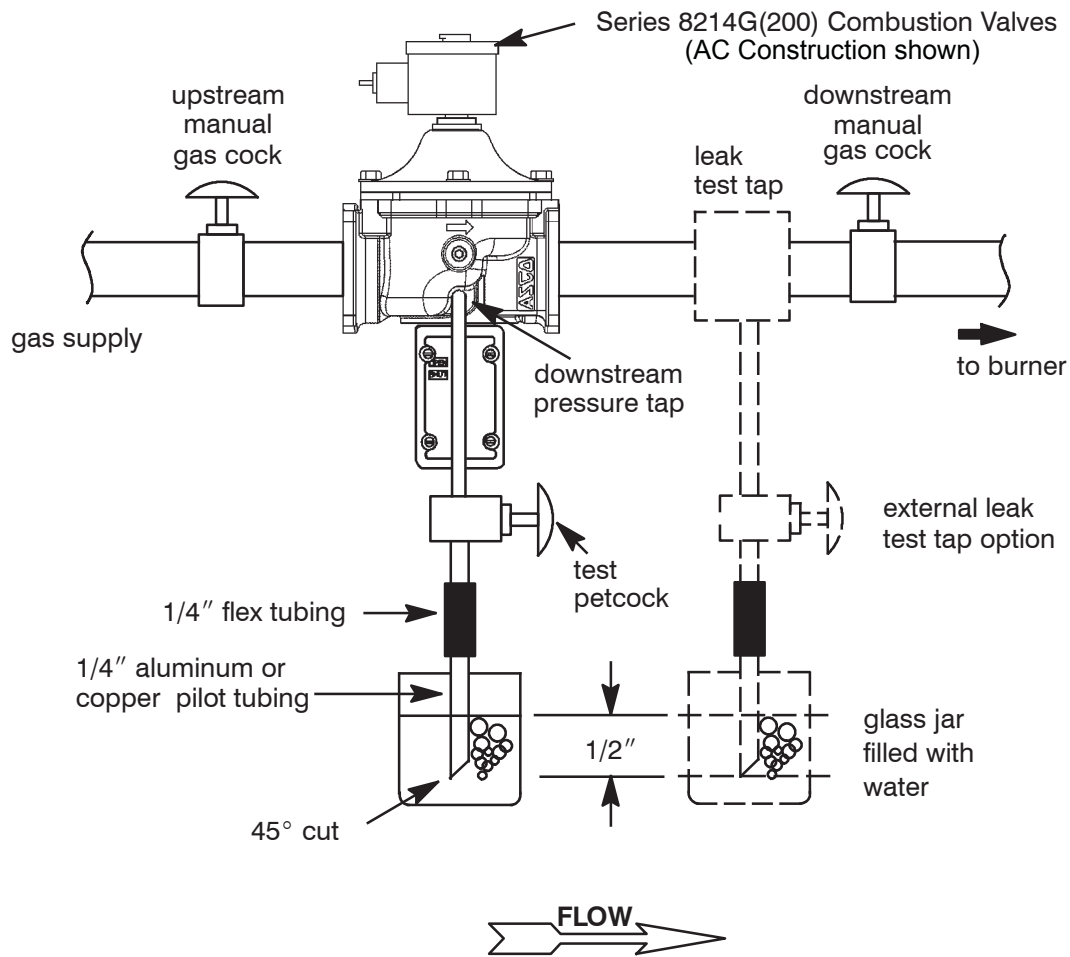

Figure 5. Testing for Internal Seat Leakage