

DIMENSIONS & DATA CERTIFIED FOR:

Representative:

Order:

Customer:

Order:

Project:

Requirements:

By:

Date:

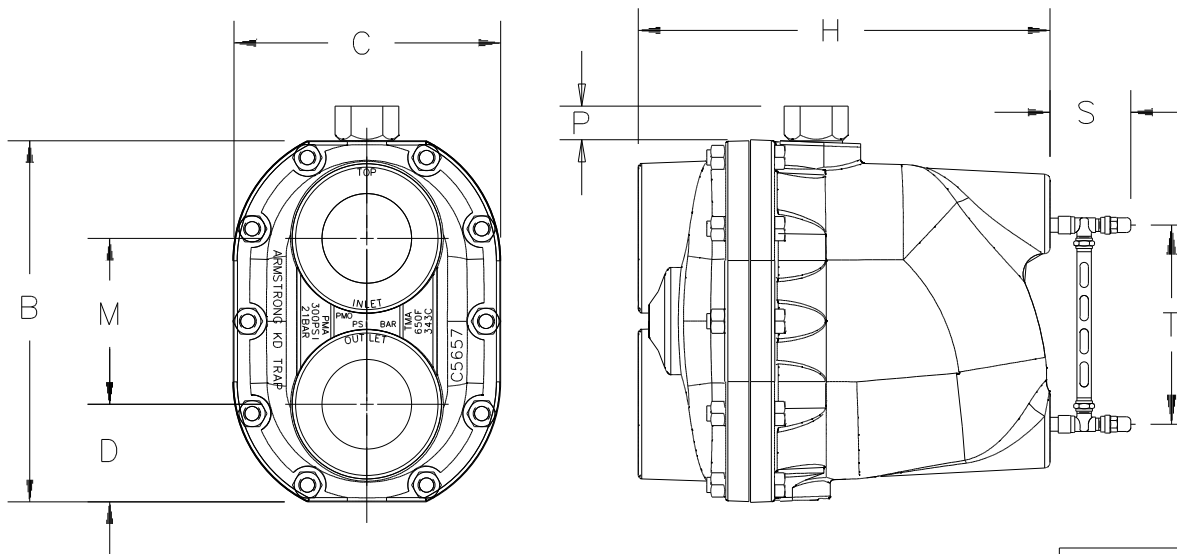

NPT CONNECTION SIZES	
JD	2[DN50]
KD	2[DN50]
	2-1/2[DN65] 3[DN80]

LIST OF MATERIALS

NAME OF PART	MODEL	MATERIAL
Cap and Body	JD & KD	ASTM A395
Cap Extension*	KD	ASTM A747 Grade CB7Cu-1, 17-4 PH
Cap Bolting	JD & KD	ASTM A307 Grade B
Cap Gaskets	JD & KD	Flexible Graphite
Valve		ASTM A582 T440C
Valve Seat		Hardened Stainless Steel
Float		ASTM A167 T304 SS
Mechanism		ASTM A276 T304 SS
Balanced Pressure Thermostatic Air Vent		ASTM A167 T304 SS Shell & Bronze/ Phosphor Bellows

OPTIONS:

- "JD" & "KD" Series available with armored gauge glass which must be specified on original order. Maximum allowable pressure, 250 psig at 425°F.
- All Armstrong F&T traps are available with integral vacuum breakers for service pressures up to 150 psi. Suffix "VB" to model number.

* 'JD' Series does not have cap extension.

DESCRIPTION	TRAP SERIES	
	JD	KD
B (Height)	13-1/6[332]	
C (Width)	9-11/16[246]	
D (Bottom to ϕ)	2-15/16[75]	3-9/16[90]
H (Length)	13-11/16[348]	14-11/16[373]
M (ϕ to ϕ)	6-5/8[168]	6 [152]
P (Trap top to VB top)	1-13/16[46]	
S (Gage Glass Width)	4-1/2 [114]	
T (Gage Glass Height)	8-3/4 [222]	
Weight (lbs)	86[39kgs]	100[45kgs]
Maximum Allowable Pressure (Vessel Design)	300 psig [21 bar] at 650°F [343°C]	

Note: Dimensions are in Inches[mm]



Armstrong International, Inc.
Three Rivers Division
Three Rivers, MI 49093

Armstrong (269) 273-1415 Fax(269) 278-6555
Posted on Armstrong's homepage www.armstrong-intl.com

Product	CD No.	Date
TRAP, DRAIN JD & KD SERIES	1302	5/19/05
		Rev. A