

# DIMENSIONS & DATA CERTIFIED FOR:

Representative:

Order:

Customer:

Order:

Project:

Requirements:

By:

Date:

## LIST OF MATERIALS:

NAME OF PART	MATERIAL
BODY & RETAINER	ASTM A48 CL. 30
STANDARD SCREENS	T304 SS .045 PERF.(1) Or T304 SS 30 MESH(41)
GASKET	NON ASBESTOS

## TECHNICAL INFORMATION

DESCRIPTION	DIMENSIONS	
<b>CONNECTION (NPT)</b>	<b>1/2 [DN15]</b>	<b>3/4 [DN20]</b>
"A" (FACE TO FACE)	4-1/4 [108]	
"B" (BOTTOM TO $\phi$ INLET)	3 [76]	
"C" (BLOW DOWN THREAD)	3/8 NPT [DN10]	
"D" (DIA. OF SCREEN)	13/16 [21]	31/32 [25]
"L" (LENGTH OF SCREEN)	2-1/16 [52]	2-3/8 [60]
WEIGHT	1-3/4 lb [.8 kgs]	3 lb [1.4 kgs]
<b>CONNECTION (NPT)</b>	<b>1" [DN25]</b>	<b>* 1-1/4 [DN32]</b>
"A" (FACE TO FACE)	5 [127]	5-1/2 [140]
"B" (BOTTOM TO $\phi$ INLET)	3-3/4 [95]	3-7/8 [98]
"C" (BLOW DOWN THREAD)	1/2 NPT [DN15]	
"D" (DIA. OF SCREEN)	1-3/16 [30]	1-1/2 [38]
"L" (LENGTH OF SCREEN)	2-15/16 [75]	2-3/8 [86]
WEIGHT	4-1/2 lb [2 kgs]	7 lb [3.2 kgs]
<b>CONNECTION (NPT)</b>	<b>1-1/2 [DN40]</b>	<b>2 [DN50]</b>
"A" (FACE TO FACE)	6-5/16 [160]	7-1/2 [191]
"B" (BOTTOM TO $\phi$ INLET)	4-7/16 [113]	5-15/32 [139]
"C" (BLOW DOWN THREAD)	1/2 NPT [DN15]	
"D" (DIA. OF SCREEN)	2 [50]	2-3/8 [60]
"L" (LENGTH OF SCREEN)	3-3/4 [95]	4-5/8 [117]
WEIGHT	11 lb [5 kgs]	15 lb [7 kgs]

## DESIGN INFORMATION

MAXIMUM ALLOWABLE PRESSURE (VESSEL DESIGN)	250 psig at 406°F [17 bar at 208°C]
	400 psig at 150°F [27 bar at 65°C]

Dimensions Are In Inches[mm]

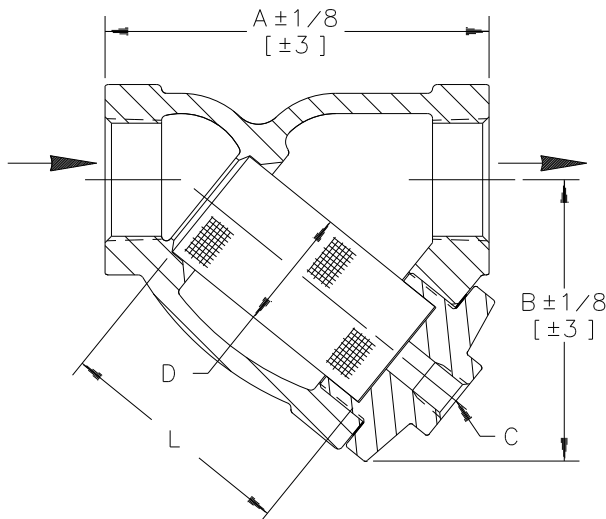

2 [DN50] Strainer Shown Above

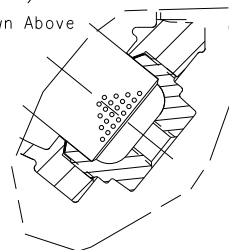

\* 1-1/4[DN32] Strainer Retainer Shown Above