

DIMENSIONS & DATA CERTIFIED FOR:

Representative:

Order:

Customer:

Order:

Project:

Requirements:

By:

Date:

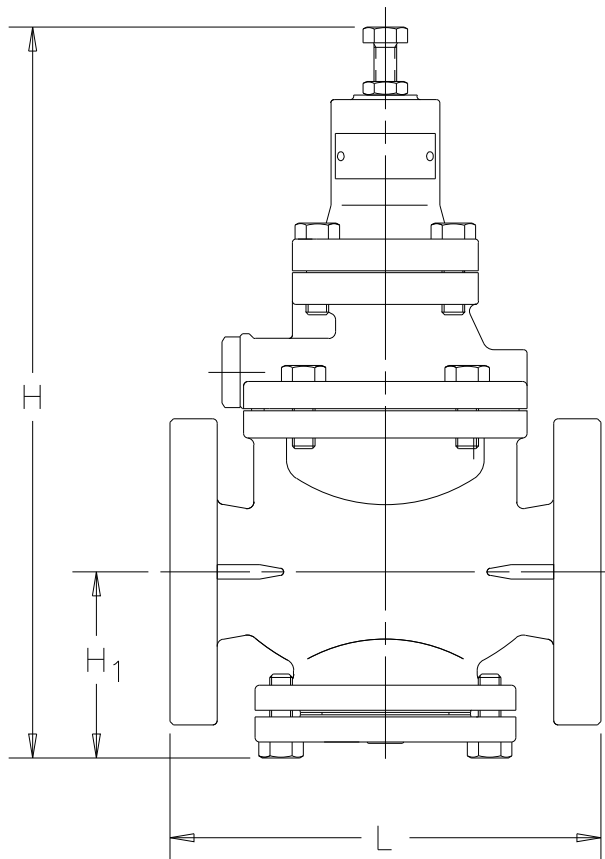

DIMENSIONS & WEIGHTS

CONN. SIZE	L	H	H ₁	WEIGHT	C _v [K _v]
2 [50]	8.7 [220]	13.7 [347]	3.7 [93]	44 lbs [20.0 kg]	16.0 [13.9]
2-1/2 [65]	9.6 [245]	14.0 [357]	3.9 [100]	66 lbs [30.0 kg]	25.0 [21.6]
3 [80]	11.4 [290]	15.9 [404]	4.8 [122]	77 lbs [35.0 kg]	36.0 [31.2]
4 [100]	13.0 [330]	17.7 [450]	5.7 [144]	116 lbs [52.5 kg]	64.0 [55.5]

DIMENSIONS IN [] ARE METRIC.

LIST OF MATERIALS

BODY	DUCTILE IRON ASTM A536
MAIN VALVE	STAINLESS STEEL AISI 420
MAIN VALVE SEAT	STAINLESS STEEL AISI 420
PILOT VALVE	STAINLESS STEEL AISI 316
PILOT VALVE SEAT	STAINLESS STEEL AISI 304
DIAPHRAGM	STAINLESS STEEL AISI 301
PISTON	BRONZE ASTM B16
CYLINDER	BRONZE ASTM B584
BOLTING	ALLOY STEEL SAE 4137

SPECIFICATIONS

APPLICATION	STEAM
INLET PRESSURE	15 - 150 psig [1 - 10.3 bar]
REDUCED PRESSURE	5 - 125 psig [0.5 - 8.6 bar]
MAX. TEMPERATURE	450°F [232°C]
MIN. DIFFERENTIAL	7 psig [0.5 bar]

NOTES;

1. MAXIMUM REDUCTION RATIO 20-1
2. ANSI CLASS IV SHUTOFF.



Product

ENGLISH

CD No.

Date

GP-1000 FLANGED
PRESSURE REDUCING VALVE

WEB
Y | N
✓

CD2105

05/18/2011

Rev; B

By; Hooley