

# DIMENSIONS & DATA CERTIFIED FOR:

Representative:

Order:

Customer:

Order:

Project:

Requirements:

By:

Date:

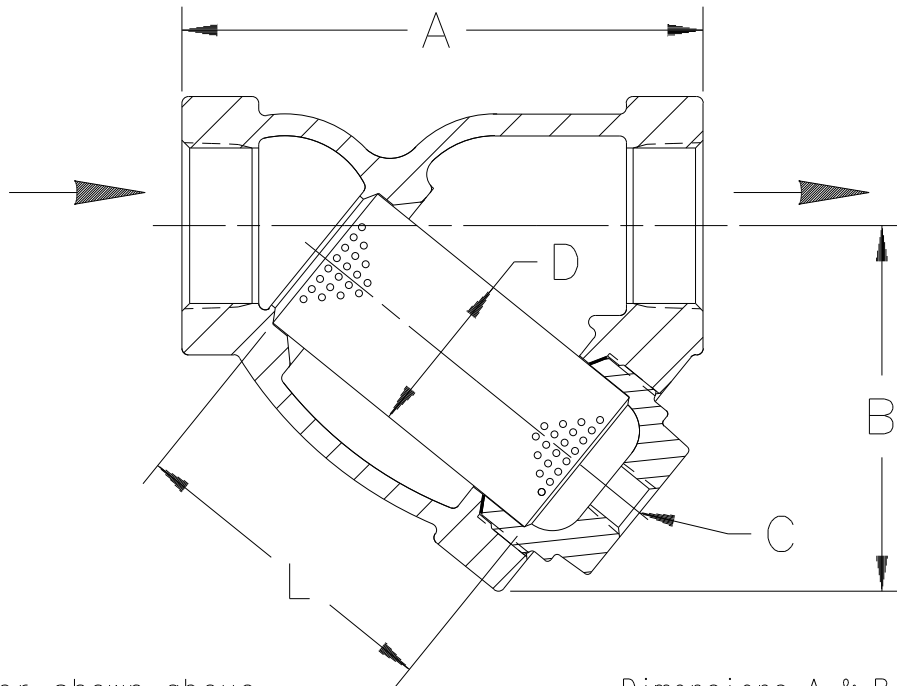

2" Strainer shown above

Dimensions A & B  $\pm 1/8"$  [3mm]

DESCRIPTION	DIMENSIONS					
CONNECTION (NPT)	1/2" [DN15]	3/4" [DN20]	1" [DN25]	1-1/4" [DN32]	1-1/2" [DN40]	2" [DN50]
"A" (FACE TO FACE)	3-3/4" [95mm]	4-1/4" [108mm]	5" [127mm]	5-1/2" [140mm]	6-5/16" [160mm]	7-1/2" [191mm]
"B" (BOTTOM TO $\phi$ INLET)	2-5/8" [67mm]	3" [76mm]	3-3/8" [86mm]	3-7/8" [98mm]	4-1/2" [114mm]	5-1/4" [133mm]
"C" (BLOW DOWN THREAD)	3/8" NPT [DN10] / 1/2" NPT [DN15]					
"D" (DIA. OF SCREEN)	13/16" [21mm]	31/32" [25mm]	1-3/16" [30mm]	1-1/2" [38mm]	2" [51mm]	2-3/8" [60mm]
"L" (LENGTH OF SCREEN)	2-1/16" [52mm]	2-3/8" [60mm]	2-15/16" [75mm]	3-3/8" [86mm]	3-3/4" [95mm]	4-5/8" [117mm]
WEIGHT	1-3/4 lb [.8 kgs]	3 lb [1.4 kgs]	4-1/2 lb [2 kgs]	7 lb [3.2 kgs]	11 lb [5 kgs]	15 lb [6.8 kgs]
MAXIMUM ALLOWABLE PRESSURE (VESSEL DESIGN)	250 psig at 406°F [17.2 bar at 208°C] 400 psig at 150°F [27.6 bar at 65°C]					

## LIST OF MATERIALS

NAME OF PART	MATERIAL
BODY	ASTM A48 CL. 30
SCREEN	T304 SS .045" PERF.
GASKET	1/2"-1" SOFT STEEL 1-1/4"-2" CLAD NON-ASBESTOS
RETAINER	1/2" & 3/4" ASTM A108 GR. 1215 1"-2" ASTM A48 CL. 30



Armstrong International, Inc.  
Three Rivers Division  
Three Rivers, MI 49093

**Armstrong** (269) 273-1415 Fax(269) 278-6555  
Posted on Armstrong's homepage [www.armstrong-intl.com](http://www.armstrong-intl.com)

Product	CD No.	Date
A1SC STRAINER 1/2" - 2" CAST IRON	1042	9/3/96
		Rev. A