

An Innovative approach to the problem of eliminating air from HVAC system piping.

#### Features

- \* Positive venting action at all operating pressures.
- \* Large 5/32" orifice eliminates large volumes of air at low as well as high pressures.
- \* Designed to eliminate air as fast as it can be separated.
- \* Self cleaning operating mechanism provides maintenance free operation.
- \* Rapid positive seating action.
- \* Will not open if negative pressure occurs so air cannot be drawn into the system.
- \* Ideal for use with air elimination and deaeration procedures.

|                             |                           |
|-----------------------------|---------------------------|
| <b>Operating Pressures:</b> | <b>0 PSIG to 150 PSIG</b> |
| <b>Max. Temperature:</b>    | <b>250°F</b>              |

#### MATERIALS OF CONSTRUCTION

| DESCRIPTION    | STANDARD CONSTRUCTION |
|----------------|-----------------------|
| BODY           | CAST IRON             |
| COVER          | CAST IRON             |
| NUTS AND BOLTS | S.S.                  |
| VENT MECHANISM | BRONZE                |

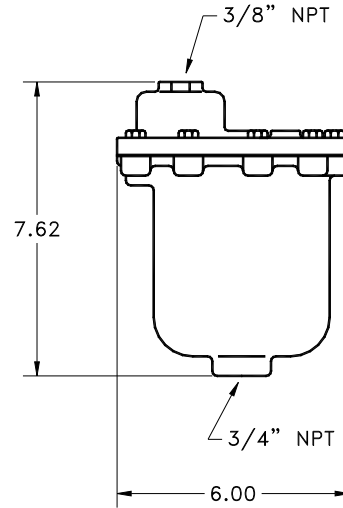

**Air Elimination vs. System Pressure**

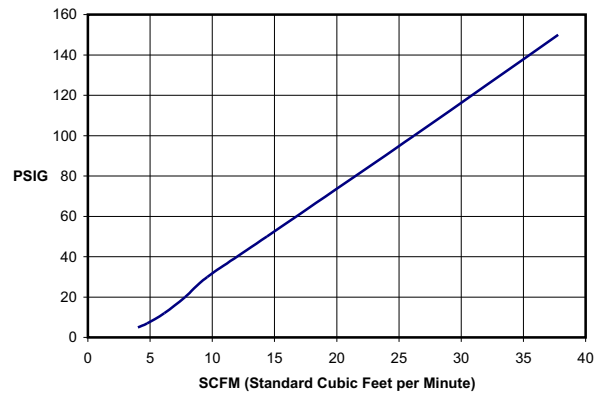

Job Name \_\_\_\_\_  
 Location \_\_\_\_\_  
 \_\_\_\_\_  
 Engineer \_\_\_\_\_  
 Architect \_\_\_\_\_  
 Sales Rep. \_\_\_\_\_  
 Contractor \_\_\_\_\_

Model Number \_\_\_\_\_  
 Notes \_\_\_\_\_  
 \_\_\_\_\_  
 \_\_\_\_\_  
 \_\_\_\_\_  
 \_\_\_\_\_